

Legend

SAUNA AND HOT TUB



English

Enjoy ultimate relaxation and recovery with hand-made Harvia Legend sauna and hot tub

HARVIA LEGEND SAUNA

Handmade sauna with a large panoramic window

Harvia Legend sauna honors old Finnish traditions and includes all the elements that make sauna and sauna-bathing beyond relaxing and magical. The dark interior of the Harvia Legend sauna makes a cozy atmosphere where you want to enjoy the silence while soft steam nourishes your skin. The large and spectacular panoramic window offers endless opportunities to enjoy the scenery while taking a sauna. The sauna has been designed by carpenter Mika Pitkänen and represents the high quality of craftsmanship.

The sauna comes as a ready-made on-site module, with plug and play electricity connections. The Legend sauna includes pre-installed, atmospheric LED lights and liftable benches which makes cleaning of the sauna easy. Harvia's Legend sauna is insulated, so the sauna is energy efficient and suitable for even colder areas. Insulation also speeds up heating and affects the retention of heat in sauna.

HARVIA LEGEND DRESSINGROOM

Plug & play dressing room to extend your sauna experience

Harvia Legend sauna is available with or without a dressing room. Harvia Legend dressing room is made from the same material as the Legend sauna, and it fits into the sauna perfectly and seamlessly. The dressing room module has four walls and can be bought separately without the sauna or together with the sauna. The Legend dressing room can also be retrofitted.



HARVIA LEGEND HOT TUB

Easy to maintain hot tub for 4-6 persons

While enjoying the soft steams in a Legend sauna why not take a dip in the hot tub? Harvia Legend Hot tub completes your sauna experience and takes your relaxation to another level. The dark outer surface and small details of the hot tub matches completely with the Legend sauna.

The Legend hot tub is easy to maintain with a large plastic pool inside. This time-resistant model can fit in 4 to 6 persons and is suitable for versatile use from evening parties to family moments.

The Legend hot tub features a Legend stove that is easy to maintain. Its large glass hatch allows you to see easily if more wood needs to be added while you can enjoy the roaring fire of the stove and warming water of the hot tub.

HARVIA ADDITIONAL ELECTRIC HEATER FOR HOT TUBS

High quality & compact-sized heater to keep your hot tub ready

Harvia's additional heater is high-quality electric heater that is made and designed in Finland to be used outdoor with hot tubs. The additional heater keeps water temperature steady and fastens the heating of the water. When the additional heater is used together with the hot tub's stove it fastens the water heating. You can also use the heater independently to maintain the water temperature.

The additional heater is safe to use and an ecological solution for heating the hot tub. The heater is easy to connect to the stove and plug to the main electricity. You just need to adjust the heater temperature to suit your needs.

Carefully selected materials and components ensure the high-quality and a long product life of the heater. The frame of the heater is completely made of strong stainless steel and the heating elements are made of titan. The heater is easy to maintain, and spare parts are available if needed.



TECHNICAL DETAILS



SHL3410

Harvia Legend Sauna Wood-burning with
Harvia Legend 240 GreenFlame heater



SHL3506

Harvia Legend Sauna Wood-burning
with Harvia Legend 240 heater



SHL3499

Harvia Legend Sauna Electric

HARVIA LEGEND SAUNA

Features

- Color black painted softwood plywood and waned softwood
- Smoke gray tempered heat glass window
- Smoke gray glass door with magnetic lock. Sauna's door can be locked only when the sauna is not in use. The lock prevents the door from opening in harsh weather and secures that children cannot enter the sauna without the presence of adults.
- Delivered assembled (heater and chimney is installed on site)
- Number of persons: 4 to 6

Dimensions

- Depth 2300 x width 2250 x height 2550 mm
- Internal volume: 8.6 m³
- Window height 1840 x width 1950 mm
- Sauna weight 1100 kg (excl. heater & stones)

Interior surface material

- Softwood plywood and waned softwood

Outside materials

- Softwood plywood and waned softwood
- Ceiling beams 45 x 95 mm
- Wall thickness on sidewalls 122 mm & on back wall 137 mm
- Insulation 30 mm Segmented Polyether Polyurethane (SPU)
- Roof material tin, thickness 187 mm
- Window material: Double-glazed glass (8 mm + 6 mm tempered glass), space between glasses 8 mm filled with Argon gas. The thickness of the element is 22 mm.

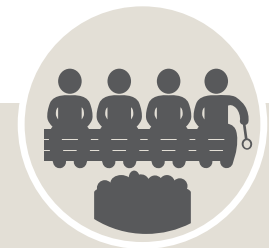

4-6 PERSONS

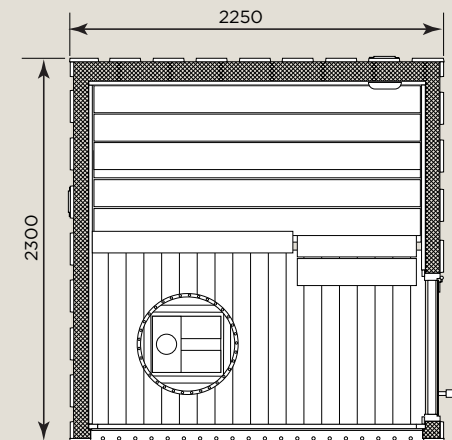

Cross-section of the wall

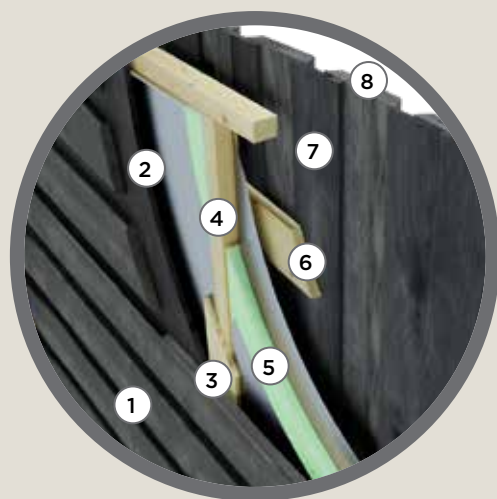

1. Inner wall – sheathed horizontal panel 22 mm
2. Plywood 9 mm
3. Inner wall vertical framing 9 mm
4. Frame 45 mm (Note: the frame on the rear wall is 70 mm)
5. Aluminum-coated insulation 30 mm (polyurethane)
(The insulation is inside the frame and creates a 15 mm air gap)
6. Outer wall horizontal framing 15 mm
7. Plywood 9 mm
8. Outer wall – sheathed vertical panel, 22 mm

HARVIA LEGEND SAUNA HEATER OPTIONS

Harvia Legend 240

The Harvia Legend 240 is an excellent choice for a medium-sized sauna. The stove is equipped with a cast-iron-framed glass door, allowing the warm glow of the fire to add to the ambience in the sauna. The stove is equipped with adjustable feet for easier installation.

Harvia Legend 240 GreenFlame

Fire roars cleanly behind the large glass door of the Harvia Legend 240 GreenFlame wood burning heater, and you can just enjoy the magical and relaxing ambience. The low-emission, durable and easy-to-use sauna heater is suited to medium-sized saunas. Its hefty stone quantity guarantees a traditional, soft saunabath.

The heart of the sauna heater is a fully renewed Green-Flame fire chamber, which has been designed with clean combustion in mind. The new fire chamber reduces the particulate emissions generated by wood combustion by one fifth and carbon monoxide emissions by 70%.

Harvia Legend Pro

The Harvia Legend Pro provides you with the ultimate sauna experience. This large heater takes you back to the origins of heaters – it is a heater in its purest form. The patinated steel frame of the Harvia Legend contains a large amount of stones that gives off great steam even in large saunas as it heats up. Due to the open structure of the stone compartment, you can throw water on the entire outer surface of the heater. The heat charged in the large number of stones allows you to throw more water even at a lower temperature – you can enjoy delightfully humid steam in your sauna.

Due to its circular shape, the Harvia Legend heater can be installed in the middle of the sauna or embedded into the bench. The heater is controlled by a separate control unit.



Harvia Legend sauna with
HARVIA LEGEND 240
wood-burning heater



Harvia Legend sauna with
HARVIA LEGEND 240 GREENFLAME
wood-burning heater

Included with
the woodburning
heaters



Protective bedding
WL100



Black steel chimney
WHP1500M



Harvia Legend sauna with
HARVIA LEGEND PRO P011E 11 KW
electric heater



Harvia Legend with
XENIO CX170
control unit

Heater stones included
with the heaters



Olivine diabase
sauna heater stones
ø 10-15 cm, AC3020

TECHNICAL DETAILS



SHL3498

HARVIA LEGEND DRESSING ROOM

Features

- Color black painted softwood plywood and waned softwood
- Smoke gray tempered heat glass window
- Harvia Legend glass door. Dressing room door can be locked only when the sauna is not in use. The lock prevents the door from opening in harsh weather and secures that children cannot enter the sauna without the presence of adults.
- Delivered assembled
- Easy-to-install to the Legend sauna
- Includes hanger with LED-lights and 1250 mm wide bench
- The roof of the sauna and dressing room is connected to be waterproof with U-shaped roof tin strip.

Dimensions

- Depth 1530 x width 2300 x height 2550 mm
- Window height 400 x width 900 mm
- Dressing room weight 800 kg

Interior surface material

- softwood plywood and waned softwood

Outside materials

- Softwood plywood and waned softwood
- Ceiling beams 45 x 95 mm
- Insulation 30 mm Segmented Polyether Polyurethane (SPU)
- Roof material tin, thickness 187 mm
- Window material: Double-glazed glass (8 mm + 6 mm tempered glass), space between glasses 8 mm filled with Argon gas. The thickness of the element is 22 mm.

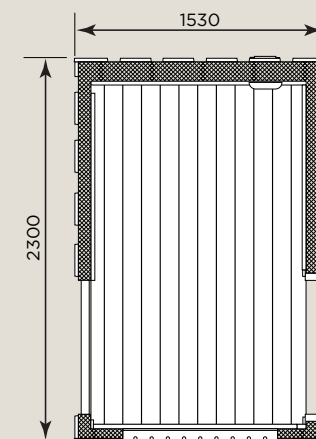



SHL3501

HARVIA LEGEND HOT TUB

Features

- Color black
- Suitable for 4 to 6 people
- The net power of the Legend stove transferred to water is circa 29 kW
- Feed-through for filter return hose

Dimensions

- Depth 910 x height 1100 mm
- Diameter 1700 mm
- Dry weight 131 kg
(weight of the pool without stove and chimney: 83 kg)
- Water volume 1540 litres (minimum 650 litres)
- Chimney Ø 150 mm, 2 m + cowl
- Chimney thermal protection 1 m
- Drainage 2 ½" female thread + hose connector 38 mm

Materials

- Wall material Dyed & heat-treated softwood plywood, 15 mm
- Insert material Polyethylene (PE) plastic approx. 8 mm thick
- Styrofoam insulation on the hot tub up to seat level

Cross-section of the hot tub

1. Rotational-moulded LDPE plastic
2. Paneling
3. EPS (polystyrene) insulation under the bench
27 cm + 10 cm at the bottom of the barrel
4. The bottom of the barrel is made of ABS plastic, which is placed against the ground. The plastic bottom protects and prevents decay



4-6 PERSONS

HOT TUB OPTIONS

Insulation cover for the hot tub

- Speeds up heating
- Keeps water hot for longer time
- Protects your hot tub from debris
- Protects inner parts of hot tub from UV-radiation
- The cover can also be folded in half and features built-in handles on sides, making it easy to lift and handle.
- Locking mechanism includes four buckled straps with safety locks which are included with the cover.
- The cover improves safety especially for families with children and pets



SHL3500

Step-in-step

- Stepin steps conform to the contours of your hot tub
- Adding a set of steps also makes getting in and out of your hot tub safer.
- These light yet durable steps are delivered pre-assembled, making them easy to install.
- The outer shell is made of Finnish spruce panels stained with a dark coal tint, and it keeps its attractive appearance for a long time.



SHL2733

Additional electric heater for hot tubs

- High-quality additional heater (3000W/230VAC) for hot tubs, possible to connect next to the hot tub's stove
- Easy to install – plug it in to the main electricity and adjust the heater temperature to suit your needs
- Made for outdoor use (IP44) and can be stored in cold conditions
- Control the temperature from the thermostat. Adjustable water temperature approx. 10-40 °C



HYB300230S



THE LEGEND FAMILY ALSO INCLUDES THESE OPTIONS

Ask more from your local dealer!



HEATER OPTIONS



Protective sheath
WL200



Legend smoke pipe
guard, WL300



Legend safety railing
SASPO240/ SASPO241



Vulcanite sauna heater stones
ø 10-15 cm, AC3045



Elite Pro Heavy Duty
sauna heater stones
ø 10-15 cm, AC3055



Rounded
sauna heater stones
ø 10-15 cm, R-995

LEGEND ACCESSORIES



Legend bucket
SASPO100



Legend ladle
SASPO101



Legend firewood rack
SASPO102



Legend clothes hanger
SASPO103



Legend thermometer
SASPO104

HARVIA

Sauna & Spa

Harvia

P.O. Box 12

FI-40951 Muurame, FINLAND

Tel. +358 207 464 000

harvia@harvia.fi

www.harvia.com